



Flip A Switch, And They're IP-Ready

Polk Audio's highly acclaimed LC265i-IP and LC80i-IP set a new, higher sonic standard for networked built-in loudspeakers. Now Polk has extended this ip-ready technology to more moderate price ranges with our new SC80-IPR and SC85-IPR speakers. The SC-IPR Loudspeakers integrate seamlessly into a legacy system or a multi-room network. Which means they represent one of the best values available in high performance, IP-ready multi-room and home theater electronics. Both models include standard speaker wire inputs for legacy systems as well as a Euro-style connector input for ip use. A rocker switch allows the installer to choose the input appropriate for the installation.

Both Loudspeakers Are IP-Ready At The Flip Of A Switch

Both models include standard speaker wire inputs for legacy systems as well as a euro-style connector input for IP use. A rocker switch allows the installer to choose the input appropriate for the installation.

And Both Loudspeakers Offer Real Benefits When Used In IP-Ready Mode

- The speakers operate in bi-amplified mode, with separate signals going to the tweeter and woofer, providing a significant performance improvement for your customer.
- When installed as part of the Netstreams Digilinx system, preloaded Digital Signal Processing (DSP) characteristics smooth the frequency response and increase the bass performance.
- Bypassing the passive crossover network creates better phase characteristics, lower overall distortion and improved sensitivity.
- MSRP SC80-IPR: \$174.95 each, SC85-IPR: \$214.95 each
- **Available January 2008**

Specifications, dimensions and features subject to change without notice. For more information call us at 1-800-377-7655 (USA and Canada). Outside of North America call +1 (410) 358-3600.



IPR Mode

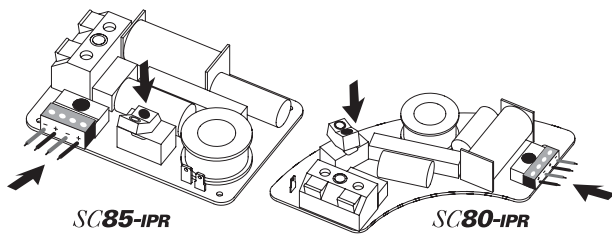

Standard Mode

